

# ORDER CODE: NSPRXX - XX - AX8XXXX - XXX - XXX

NSPR SERIES - MILD STEEL FEMALE THREAD AXLE INDUSTRIAL ROLLER

DIMENSION	MEASUREMENT
TD	
A	
OF	
OA	
EXTN	
M	
LG	

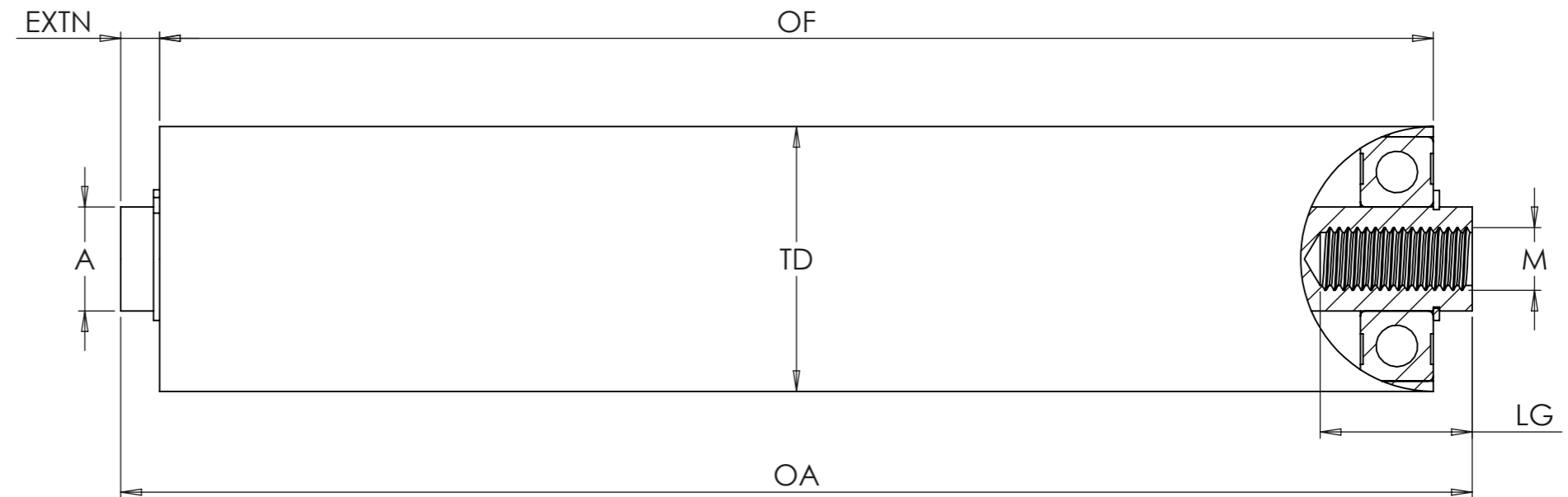

AVAILABLE WITH PLASTIC SEAL TO PROTECT BEARINGS, IF THIS IS REQUIRED OF WILL NEED TO BE ~6MM SHORTER (WE WILL CALCULATE THIS)

TUBE DIAMETER	AXLE DIAMETER		
32 X 3	10	12	-
35 X 3	12	-	-
38 X 3	11	15	-
40 X 5	12	15	17
51 X 3	20	25	-
51 X 5	20	25	30
60 X 5	20	25	30
63 X 5	20	25	-

### PART CODE BREAKDOWN

NSPR = NON SWAGE PRECISION ROLLER  
 TD = TUBE DIA (E.G. 51)  
 A = AXLE DIA (E.G. 20)  
 AX8 = FEMALE THREADED AXLE  
 OF = OVER FACE (E.G 400MM)  
 OA = OVER AXLE (E.G 410MM)  
 M = THREAD SIZE (E.G M12)  
 LG = THREAD DEPTH (E.G 25MM)

### EXAMPLE: NSPR51-20-AX81225-400-410

FOR A 51MM DIAMETER ROLLER FITTED WITH A 20MM FEMALE THREADED AXLE WITH AN THREAD SIZE OF M12 AND A DEPTH OF 25MM. ROLLER LENGTH OF 400MM AND AN AXLE LENGTH IS 410MM.

UNIT 3, ALBION WORKS  
 MOOR STREET,  
 BRIERLEY HILL,  
 WEST MIDS,  
 ENGLAND,  
 DY5 3SZ



UNLESS OTHERWISE SPECIFIED: DIMENSIONS ARE IN MILLIMETERS		DEBURR AND BREAK SHARP EDGES	DO NOT SCALE DRAWING
NAME	REVISION	DATE	FINISH: SELF COLOUR
DRAWN	K JEAVONS	1	12/01/2024
WEIGHT:			MATERIAL: MILD STEEL

COPYRIGHT RESERVED	REVISION: 1
TITLE:	
DWG NO.	A3
NSPR-ORDER-AX8	
SCALE:1:5	SHEET 1 OF 1