

PRODUCT: PR - ^{TD}XX - ^AXX - AX10 ORDER DESC.: OBXX - OAXX - AX10^D^{LC}XXX

PR1600 SERIES - MILD STEEL ROLLER WITH CROSS DRILLED AXLE - GREASED BEARINGS

DIMENSION	MEASUREMENT
TD	
A	
OB	
OA	
D	
LC	

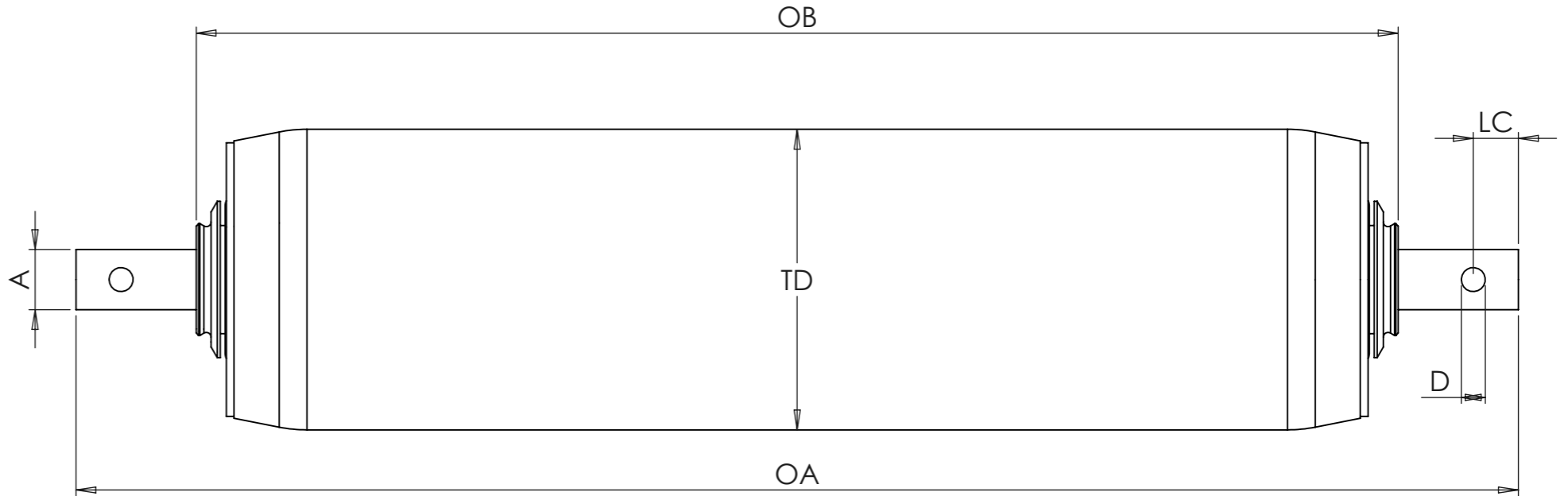

BELOW ARE TUBE DIAMETER OPTIONS, PLEASE SELECT AXLE FROM THE SAME ROW

TD	TUBE DIAMETER & THICKNESS	ROUND AXLE (A)					HEX AXLE (A)	
		∅	∅	∅	∅	∅	HEX	HEX
50	50 x 1.5	10	11	12	15	17	8H	11H
50MD	51 x 2.0	10	11	12	15	17	8H	11H
50HD	51 x 3.0	10	11	12	15	17	8H	11H
60	60 x 2.0	10	11	12	15		11H	
60HD	60 x 3.0	17						
63	63.5 x 3.0	16	20				14H	
70MD	70 x 2.0	15	17					
703	70 x 3.0	17						
803	80 x 3.0	20						

PART CODE BREAKDOWN

TD = TUBE DIAMETER
A = AXLE DIA
OB = OVER BEARING
OA = OVER AXLE

AX10 = LOOSE AXLE
D = HOLE DIAMETER
LC = HOLE LOCATION
AXLE SUPPLIED LOOSE UNLESS STATED OTHERWISE

GENERATE ORDER CODE BELOW

QTY:

TD A
D LC

PR- ___ - ___ - AX10
OB_____OA_____AX10_____

UNIT 3, ALBION WORKS MOOR STREET, BRIERLEY HILL, WEST MIDS, ENGLAND, DYS 3SZ		AED Rollers <i>Best rollers Best service</i>		COPYRIGHT RESERVED REVISION: 1	
UNLESS OTHERWISE SPECIFIED: DIMENSIONS ARE IN MILLIMETERS				DO NOT SCALE DRAWING	
NAME REVISION DATE		FINISH: BZP		DWG NO. A3	
DRAWN K JEAVONS 1 12/01/2024		MATERIAL: MILD STEEL		PR-ORDER-AX10	
WEIGHT:				SCALE:1:2 SHEET 1 OF 1	