

PRODUCT: PR-^{TD}XXKTR - ^AXX - AX3

ORDER DESC.:^{AF}OBXX - ^{LG}OAXX - AX3XXXX

PR-KTR1700 SERIES - MILD STEEL ROLLER WITH D-FLATTED AXLE

DIMENSION	MEASUREMENT
TD	
A	
OB	
OA	
EXTN	
DF	
LG	

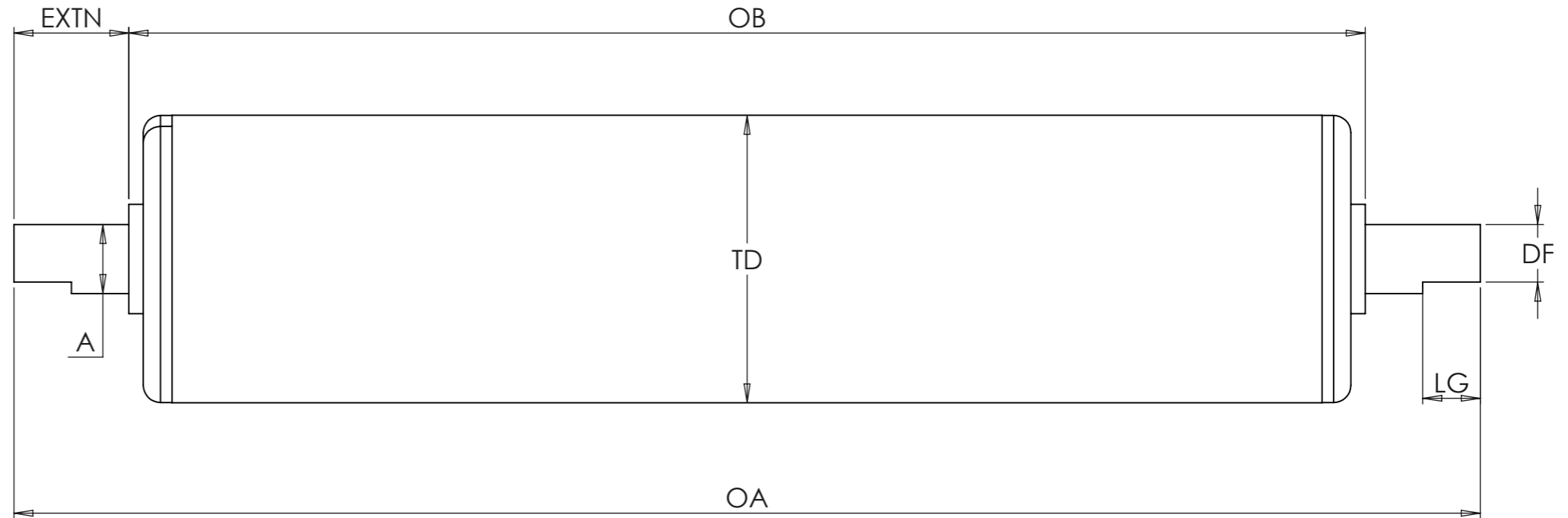

BELOW ARE TUBE DIAMETER OPTIONS, PLEASE SELECT AXLE FROM THE SAME ROW

TD	TUBE DIAMETER & THICKNESS	ROUND AXLE (A)				
		∅	∅	∅	∅	∅
35	∅35 X 1.2	8				
40	∅40 X 1.5		10	12		
50	∅50 X 1.5		10	12	14	
60	∅60 X 2		10	12	14	
63	∅63.5 X 3					20
89	∅89 X 3					20

PART CODE BREAKDOWN

TD = TUBE DIAMETER
 A = AXLE DIAMETER
 OB = OVER BEARING
 OA = OVER AXLE

AX3 = D-FLATTED AXLE
 DF = ACROSS FLAT
 LG = FLAT LENGTH

GENERATE ORDER CODE BELOW

QTY:

PR ^{TD}KTR- ^A-AX3

^{OB} - ^{OA} - AX3 ^{DF} ^{LG}

UNIT 3, ALBION WORKS
 MOOR STREET,
 BRIERLEY HILL,
 WEST MIDS,
 ENGLAND,
 DY5 3SZ



COPYRIGHT RESERVED		REVISION: 1
TITLE: PR-KTR-1700 SERIES		
DWG NO. PR-KTR-ORDER-AX3	A3	
SCALE:1:2	SHEET 1 OF 1	

UNLESS OTHERWISE SPECIFIED: DIMENSIONS ARE IN MILLIMETERS			DEBURR AND BREAK SHARP EDGES	DO NOT SCALE DRAWING
NAME	REVISION	DATE	FINISH:	
DRAWN	K JEAVONS	1	MATERIAL: STAINLESS	
		12/01/2024	WEIGHT:	