

**PRODUCT: SSRG - XXLD - XX - AX10**

**ORDER DESC: OBXX - OAXX - AX10**

LD100 SERIES - STAINLESS STEEL LIGHT DUTY GRAVITY ROLLER WITH CROSS DRILLED AXLE

DIMENSION	MEASUREMENT
TD	
A	
OB	
OA	
EXTN	
D	
LC	

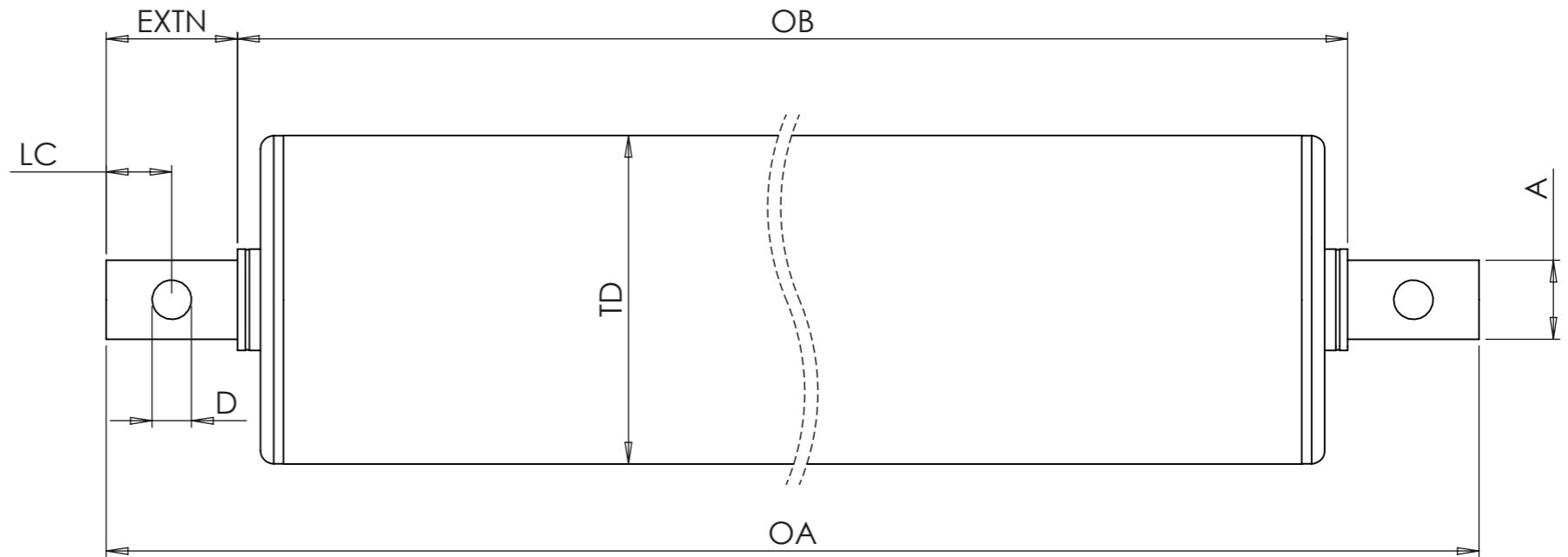

**PART CODE BREAKDOWN**

BELOW ARE TUBE DIAMETER OPTIONS, PLEASE SELECT AXLE FROM THE SAME ROW

TD	TUBE DIAMETER & THICKNESS	ROUND AXLE (A)				HEX AXLE (A)
		Ø	Ø	Ø	Ø	HEX
20	Ø20 X 1.5	6	8			
30	Ø30 X 1.5		8	10		
40	Ø40 X 1.5		8	10		
50	Ø50 X 1.5		8	10	12	11

TD = TUBE DIA  
 A = AXLE DIA  
 OB = OVER BEARING  
 OA = OVER AXLE

AX10 = CROSS DRILLED  
 D = HOLE DIAMETER  
 LC = HOLE CENTRE TO END OF AXLE  
 EXTN = AXLE EXTENSION

GENERATE ORDER CODE BELOW

QTY:

SSRG-\_\_\_\_LD-\_\_\_\_-AX10

OB\_\_\_\_-OA\_\_\_\_-AX10

UNIT 3, ALBION WORKS  
 MOOR STREET,  
 BRIERLEY HILL,  
 WEST MIDS,  
 ENGLAND,  
 DY5 3SZ



COPYRIGHT RESERVED		REVISION: 1
TITLE:		SS LD100 SERIES
UNLESS OTHERWISE SPECIFIED: DIMENSIONS ARE IN MILLIMETERS	DEBURR AND BREAK SHARP EDGES	DO NOT SCALE DRAWING
NAME	REVISION	DATE
JEAVONS	1	27/04/2026
DRAWN		WEIGHT:
FINISH: SELF COLOUR		DWG NO. LD100-ORDER-AX10
MATERIAL: STAINLESS STEEL		A3
SCALE:1:1		SHEET 7 OF 8