

PRODUCT: PRG - XX - XX - AX10

ORDER DESC: OBXX - OAXX - AX10

LD100 SERIES - PVC LIGHT DUTY GRAVITY ROLLER WITH CROSS DRILLED AXLE

DIMENSION	MEASUREMENT
TD	
A	
OB	
OA	
EXTN	
D	
LC	

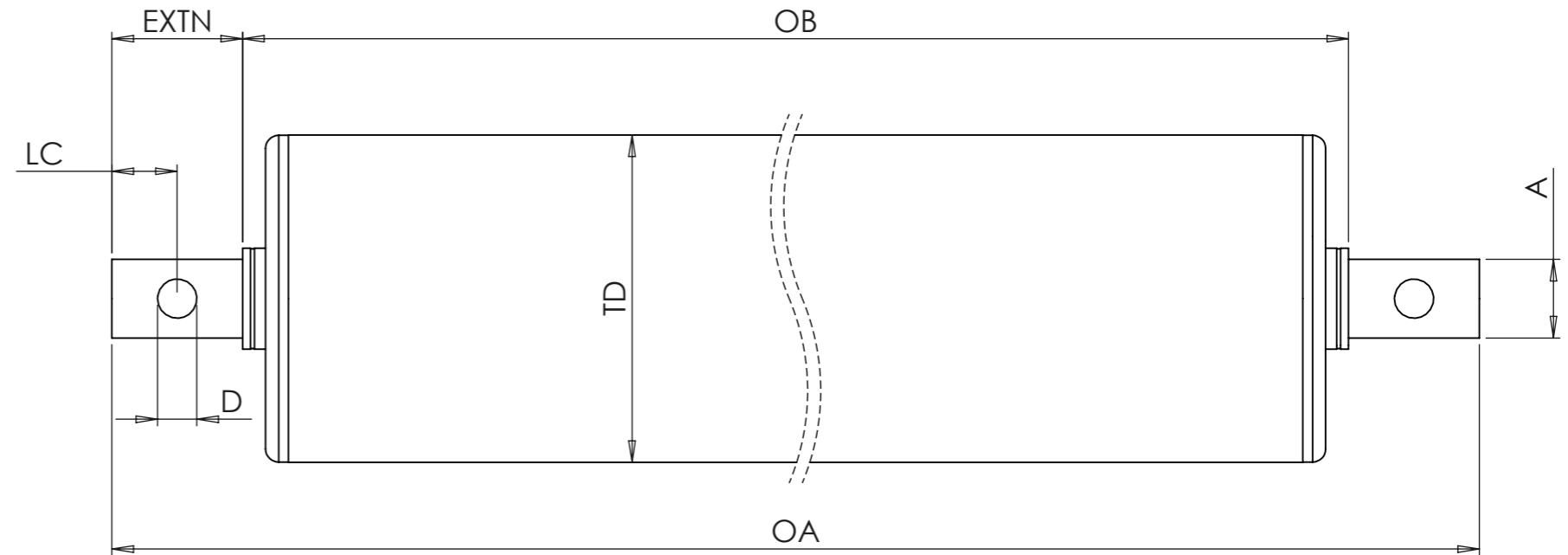

PART CODE BREAKDOWN

BELOW ARE TUBE DIAMETER OPTIONS, PLEASE SELECT AXLE FROM THE SAME ROW

TD	TUBE DIAMETER & THICKNESS	ROUND AXLE (A)				HEX AXLE (A)
		Ø	Ø	Ø	Ø	HEX
20	Ø20 X 1.5	6	8			
30	Ø30 X 2.0		8	10		
40	Ø40 X 2.0		8	10		
50	Ø50 X 3.0		8	10	12	11

AXLES ALSO AVAILABLE IN STAINLESS

TD = TUBE DIA
 A = AXLE DIA
 OB = OVER BEARING
 OA = OVER AXLE

AX10 = CROSS DRILLED
 D = HOLE DIAMETER
 LC = HOLE CENTRE TO END OF AXLE
 EXTN = AXLE EXTENSION

GENERATE ORDER CODE BELOW

QTY:

PRG-____-____-AX10

OB____-OA____-AX10

UNIT 3, ALBION WORKS
 MOOR STREET,
 BRIERLEY HILL,
 WEST MIDS,
 ENGLAND,
 DY5 3SZ



COPYRIGHT RESERVED		REVISION: 1
TITLE:		PVC LD100 SERIES
DWG NO.		LD100-ORDER-AX10
SCALE:1:1		SHEET 7 OF 8

UNLESS OTHERWISE SPECIFIED: DIMENSIONS ARE IN MILLIMETERS			DEBURR AND BREAK SHARP EDGES	DO NOT SCALE DRAWING
NAME	REVISION	DATE	FINISH: SELF COLOUR	
DRAWN	JEAVONS	1	MATERIAL: PVC	
			WEIGHT:	